

ANEXOS



FIGURA A.1 PLANO ESTRUCTURAL DE DISEÑO* DE LA CUBIERTA SUPERIOR



FIGURA A.2 PLANO ESTRUCTURAL DE DISEÑO* DE LA CUBIERTA INFERIOR

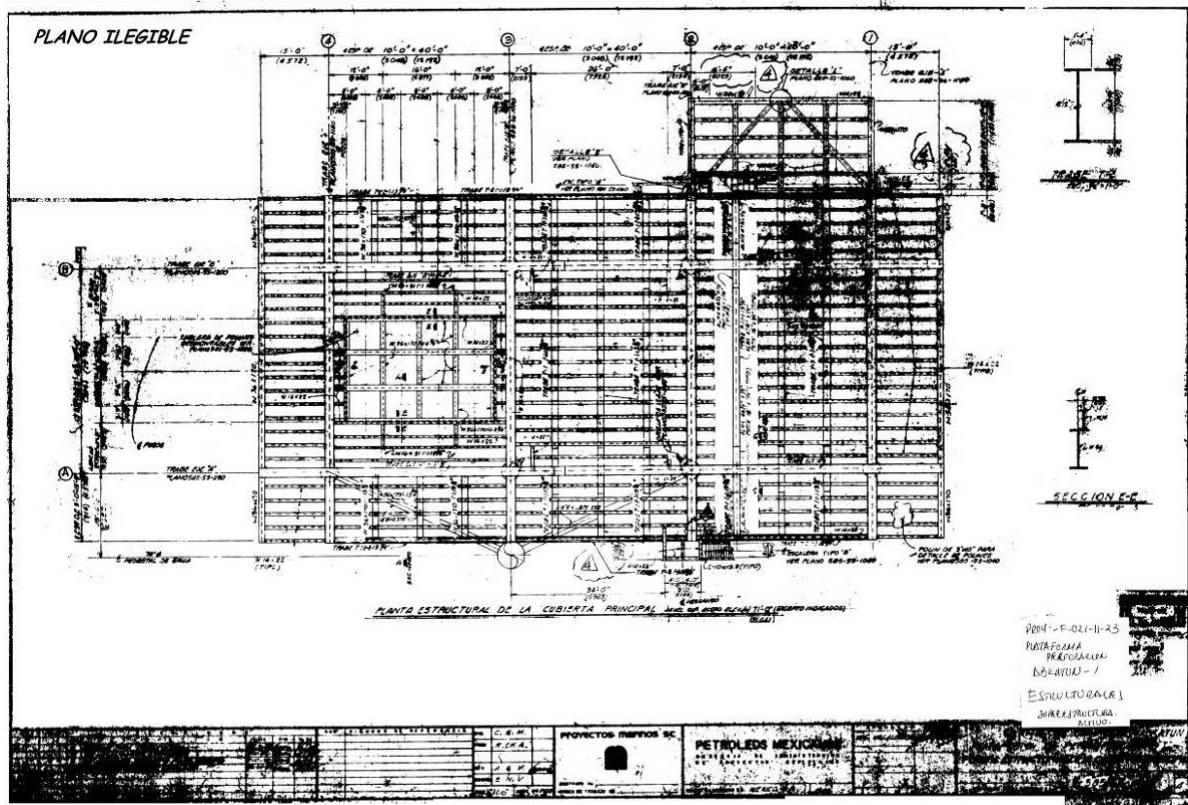

FIGURA A.3 PLANO ESTRUCTURAL ORIGINAL* DEL EJE 1

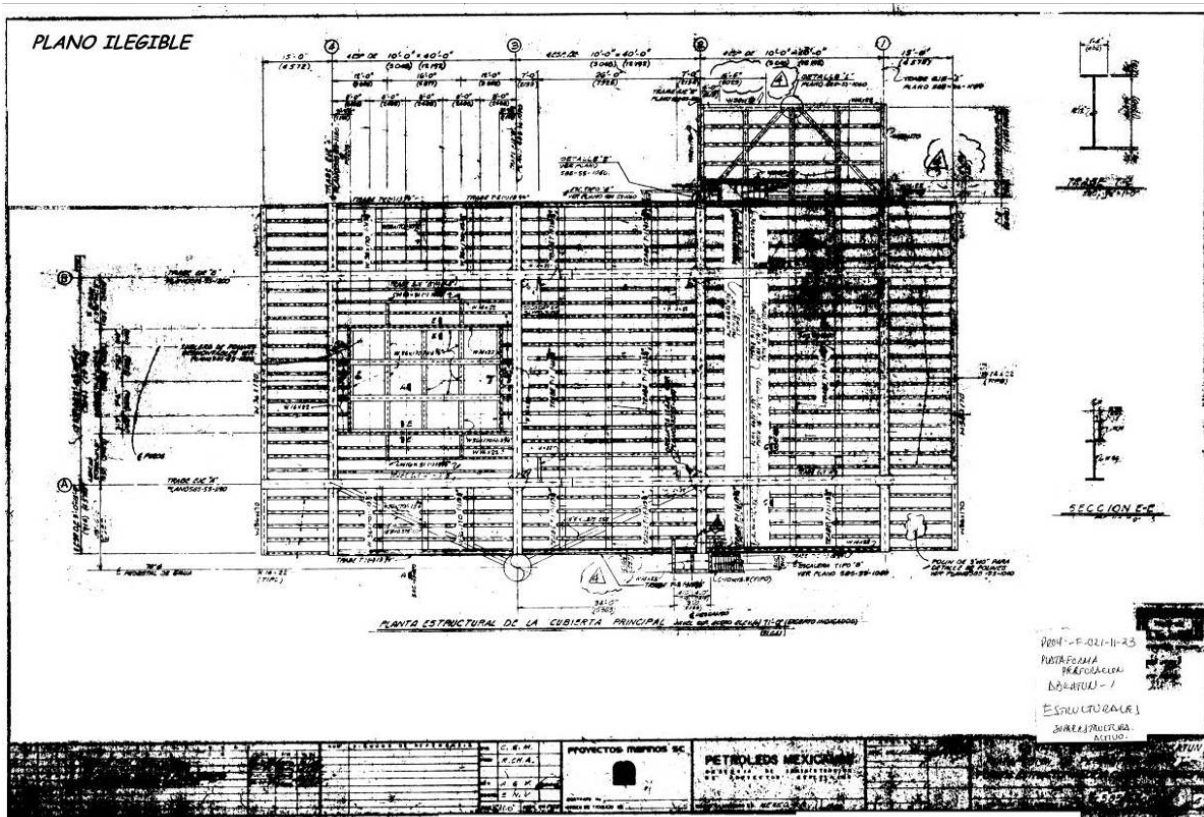

FIGURA A.4 PLANO ESTRUCTURAL ORIGINAL* DEL EJE B

* Los planos estructurales fueron emitidos para la construcción de la plataforma en Abril de 1982.

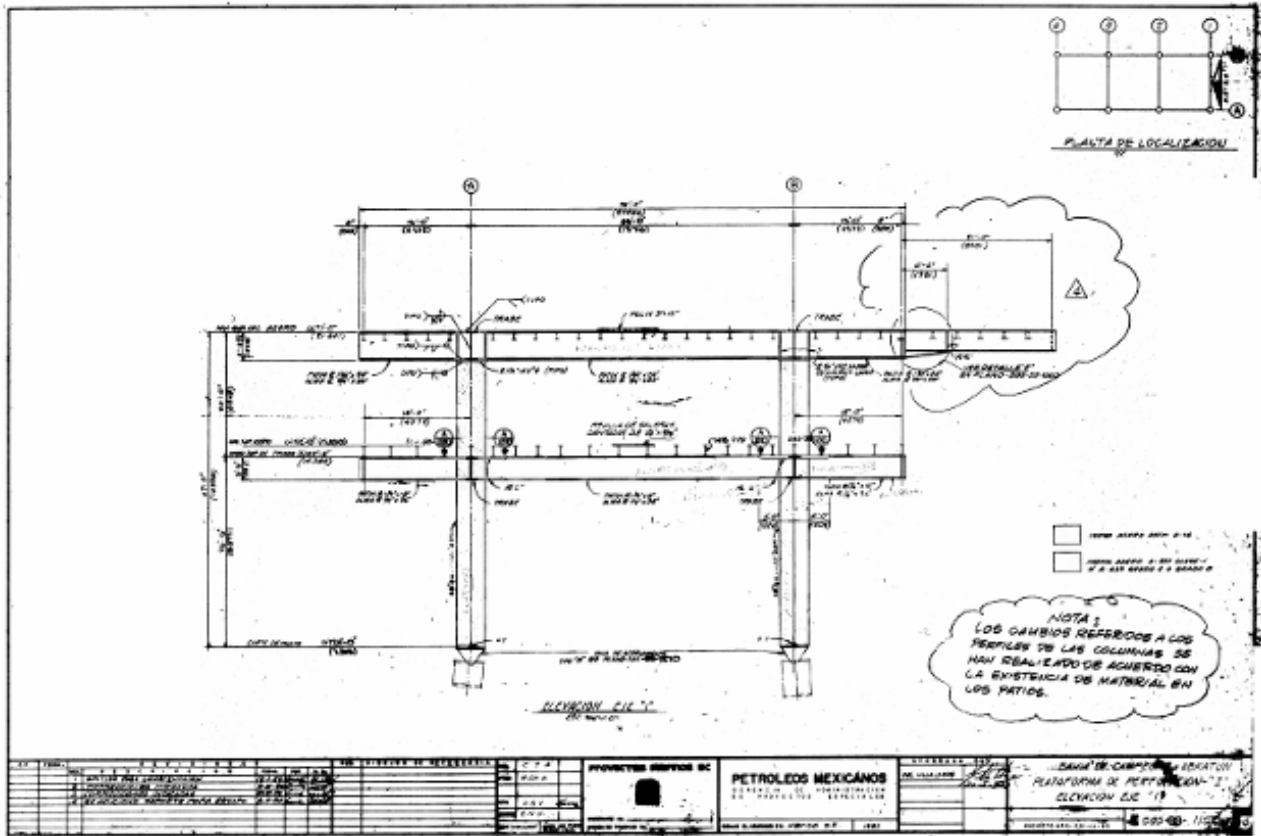

FIGURA A.5 DETALLE EN PLANTA DEL PLANO CONSTRUCTIVO DEL MARCO DE SOPORTE Y ARRASTRE DE LA SUPERESTRUCTURA

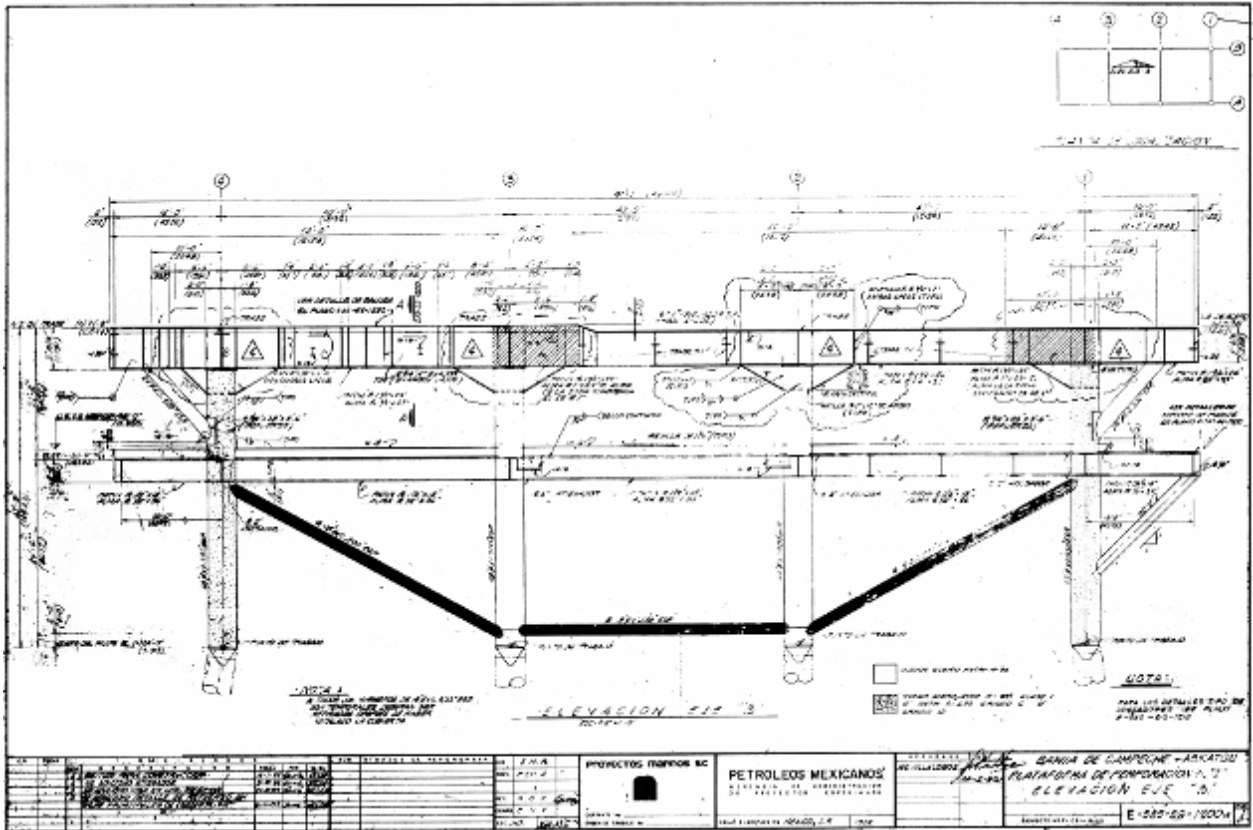

FIGURA A.6 DETALLE 1 DEL PLANO CONSTRUCTIVO DEL MARCO DE SOPORTE Y ARRASTRE DE LA SUPERESTRUCTURA

DRAHTSEILE GEBR. HENSCHEL GMBH
 Drahtseile in Grummetausführung · Drahtseile für Offshore
 Germany · Telefon : 0 21 62-7 73 74 · Telefax : 0 21 62-7 73 97

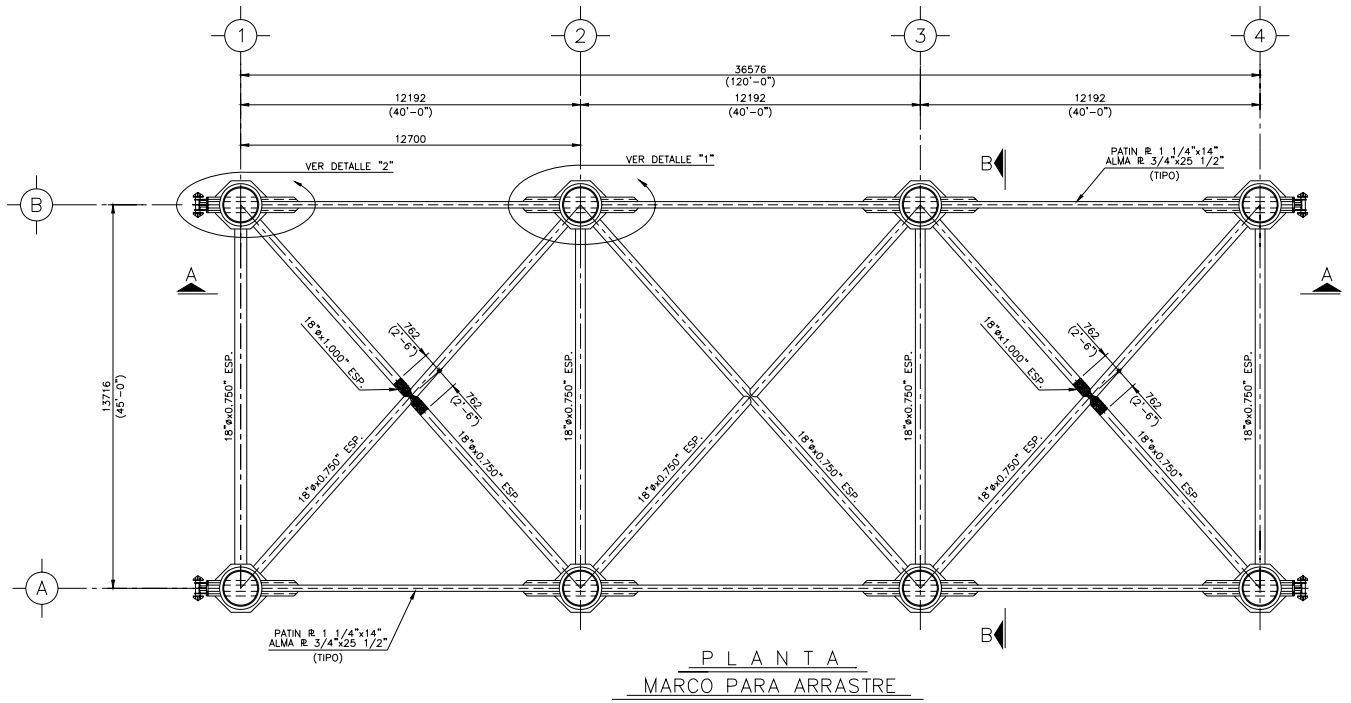

Quality System acc. to ISO 9002 and BS 5750 Part 2 approved by Lloyd's Register Quality Assurance Ltd. Reg. No. 1000177
 Berufsgenossenschaft A. B. M. 425 001 425 010 425 011

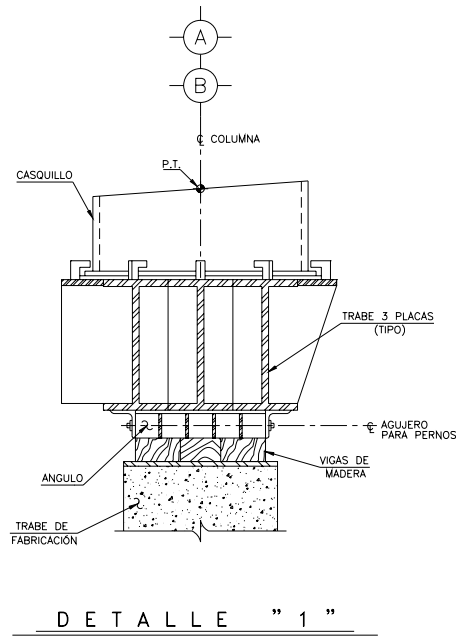
GEBR. HENSCHEL GMBH Postfach 12 92 03 41720 Viernum

Constructora y Arrendadora Mexico, S.A. de C.V.
 Mexico

CERTIFICATE OF DIMENSIONAL CONFORMITY
Cable laid grommets

In accordance with Health and Safety Executive Guidance Note PM20
 Cable laid slings and grommets

cross references with certificate no.: C.809-10-12011-87004
 Verto 001379/204161
 I.G.H 809-10

CERTIFICATE NO: D.GH 809-10

1	Consolidation certificate number:	C.809-10-12011-87004
2	Sling number	---
3	Nominal length	L2 24,4 mtr = 80'
	* circumference may be used	L4 48,8 mtr = 160'
4	Actual length	AL2 24,4 mtr = 80'
5	Nominal diameter	d 144 mm = 5 3/4"
6	Actual diameter	d
7	Eye length seized	E1 3.000 mm
8	Eye length seized	E2 3.000 mm
9	Pin diameter	D1
		D2
10	Measuring load	
11	Name and adress of maker or supplier of sling or grommet	DRAHTSEILE Gebr. Henschel GmbH D- 41749 Viernum - Süchteln

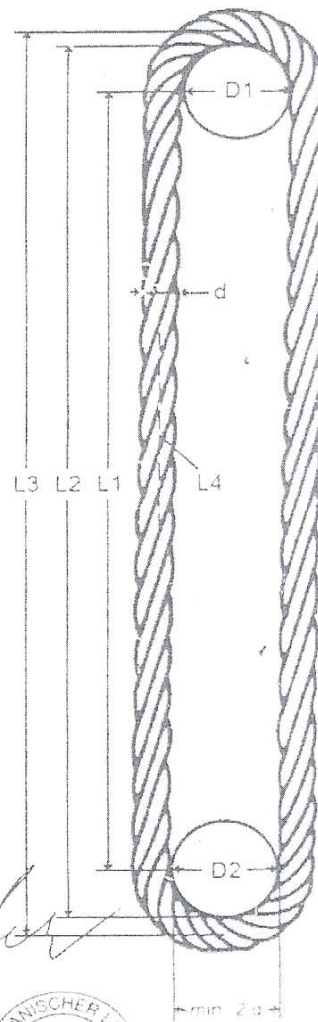

Certification

12 I certify on behalf of the firm named in 11 above that the above particulars are correct

Date: 05.10.1998

Ratification by
 Representing

0
 0
 VI BV
 Review DA
 14/10/98

Fr.-E. Roeder
 Gebr. Henschel GmbH

Signature



FIGURA A.7 CERTIFICADO DE INSPECCIÓN DE LOS CABLES DE IZAJE



FIGURA A.8 CROQUIS DE LOCALIZACIÓN DE CONTRAPESO PARA IZAJE



FIGURA A.9 RELOCALIZACIÓN DE CONEXIÓN DE ELEMENTOS TEMPORALES DE IZAJE

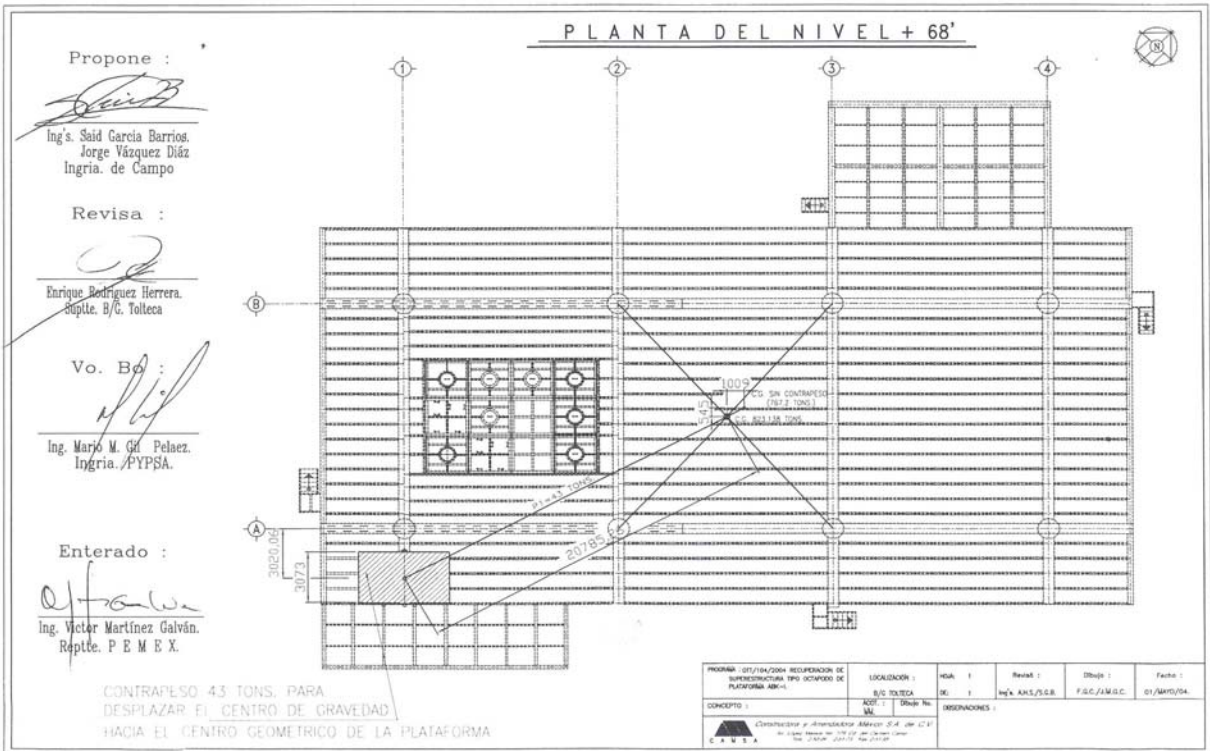

FIGURA A.10 DETALLES DE RELOCALIZACIÓN DE CONEXIÓN DE ELEMENTOS TEMPORALES DE IZAJE

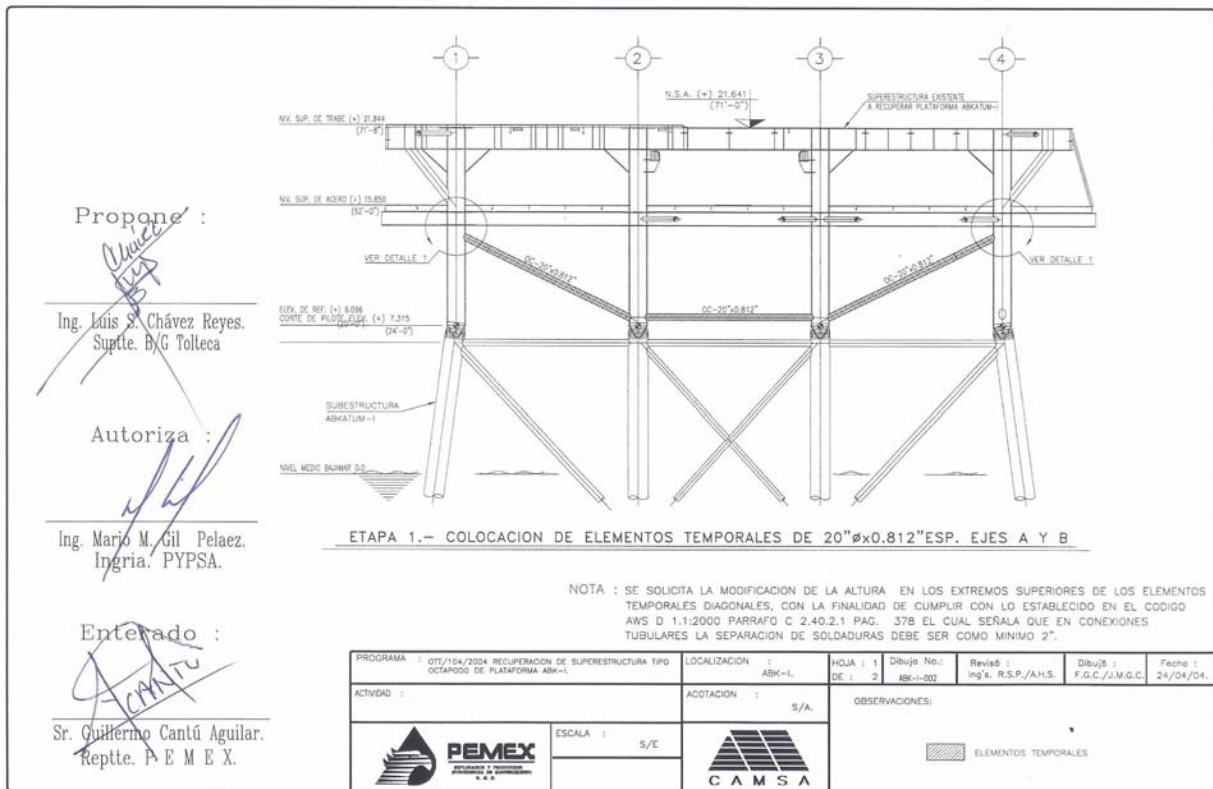
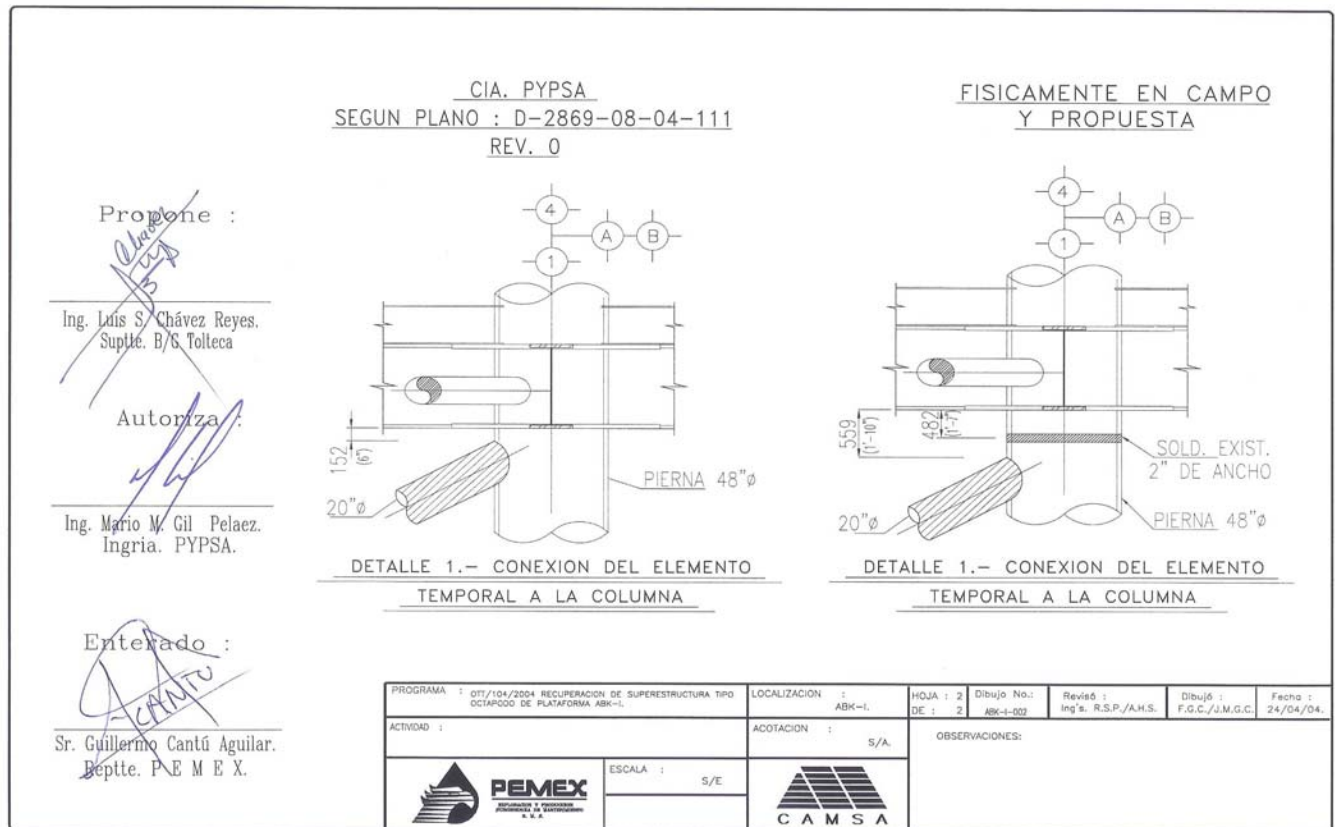
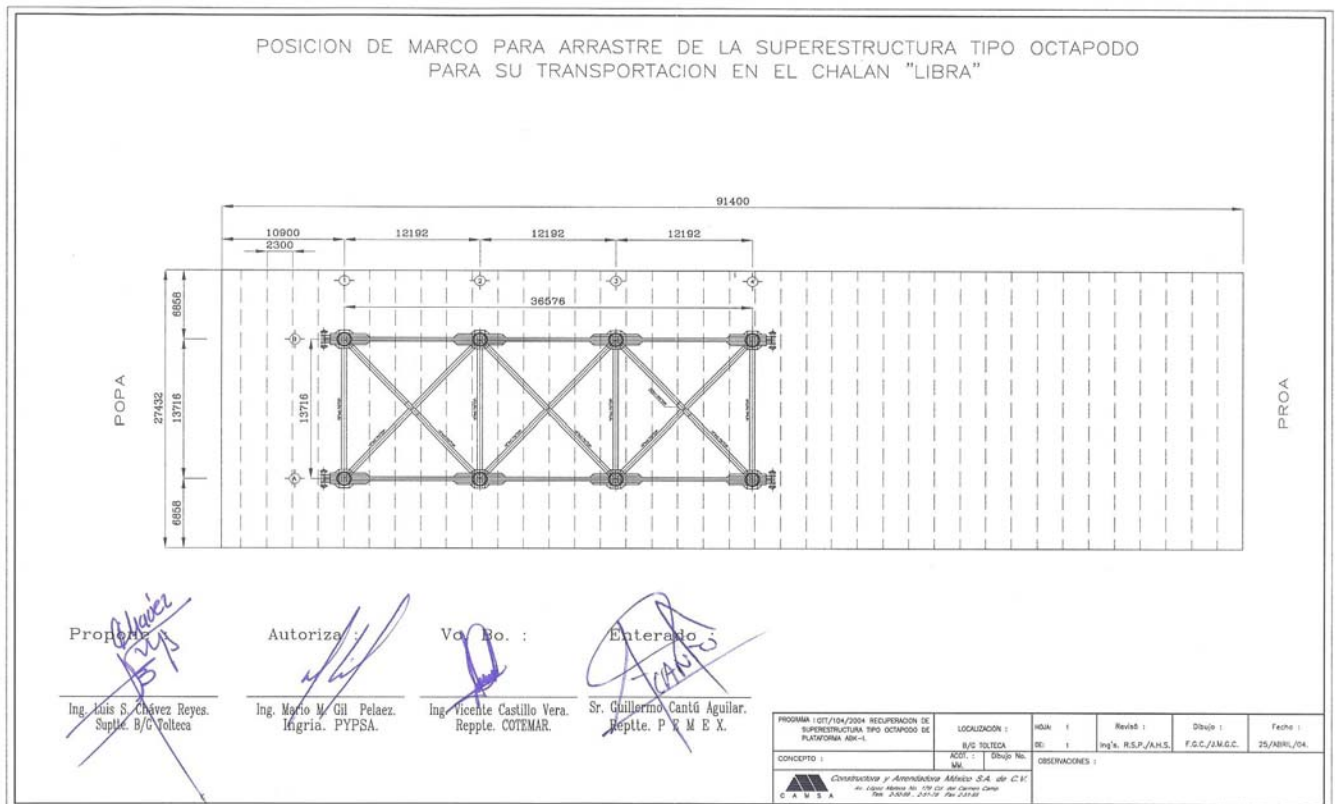

FIGURA A.11 CROQUIS DE POSICIONAMIENTO DEL MARCO SOPORTE EN EL CHALÁN DE TRANSPORTACIÓN